

THE i4.

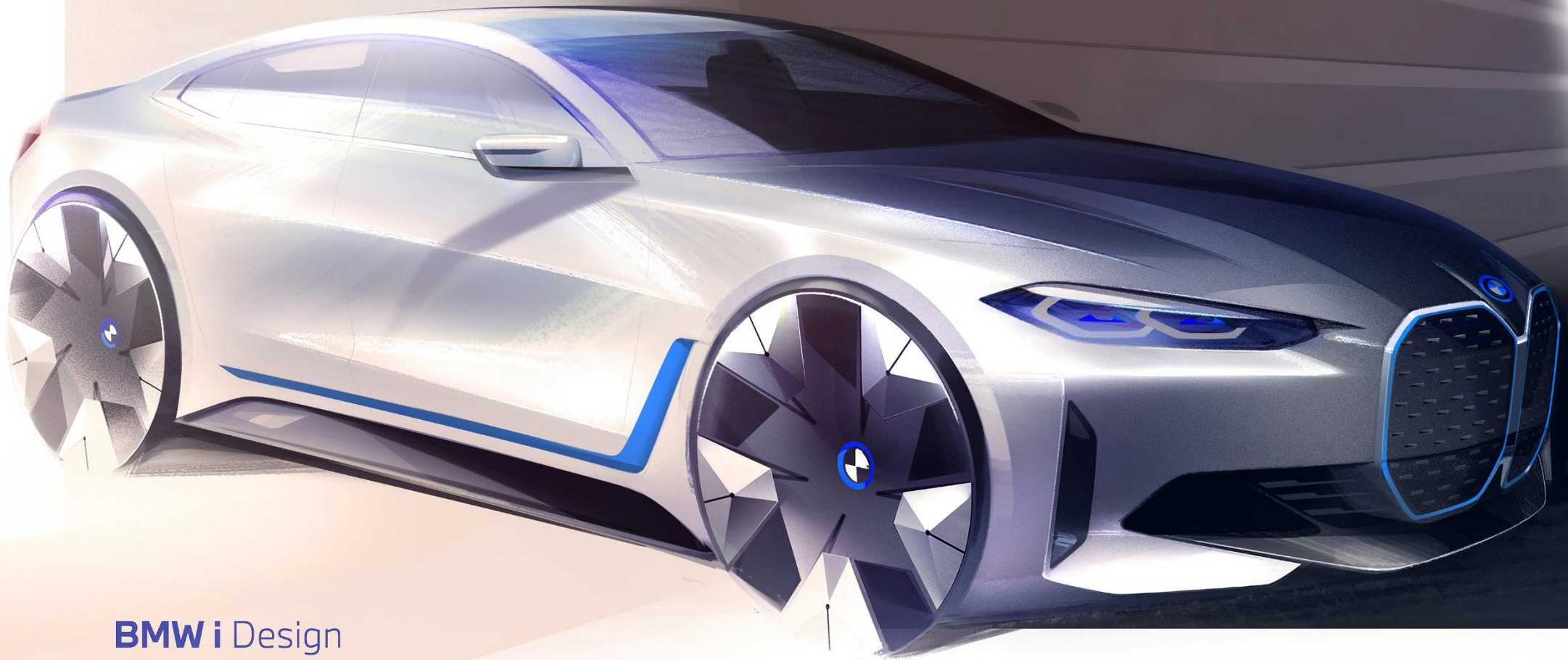

BMW i Design

UBS INVESTOR FIELD TRIP, SEPTEMBER 8, 2021

THE BMW i4. E-MOBILITY HAS REACHED THE HEART OF THE BMW BRAND.

"THE BMW i4 TRANSFERS BMW BRAND DNA AND THE BMW TYPICAL DRIVING PLEASURE INTO THE ERA OF ELECTROMOBILITY." David Ferrufino, Head of BMW i4 Project.

DESIGN.

- Pure emotion through sporty proportions with Gran Coupé character.



SPORTINESS & COMFORT.

- Perfect quartet between driving dynamics, elegance, comfort and long distance driving.

ELECTRIC DRIVING PLEASURE.

- Amazing acceleration, high range and adaptive recuperation system.

USER EXPERIENCE & CONNECTIVITY.

- Intuitive user interface and IconicSounds Electric - driving with all senses.



THE BMW i4 eDRIVE40 - EVERYTHING YOU WOULD EXPECT FROM A BMW GRAN COUPÉ.



Expressive design in high execution quality

Highly powerful & efficient drivetrain for BMW i4 eDrive40.

- ▶ 250 kW.
- ▶ 5.7 sec 0-100 km/h.
- ▶ 16.1 – 19.1 kWh/100 km (WLTP).
- ▶ Up to 590 km range (WLTP).
- ▶ max. 205 kW DC charging; 164 km range per 10 mins

Superior Driving Dynamics & Comfort.

Centre of gravity 53 mm lower than BMW 3 Series.

Total LCA CO₂ balance 30-60% better than comparable ICE model.

BMW typical range of options for maximum individualization.

Large tailgate for easy access to 470 - 1,290 litres cargo space. Rear view camera as standard, smart tailgate with foot activation for opening and closing as optional equipment.

Comprehensive BMW Charging Portfolio.
€ 0.33/kWh AC charging,
€ 0.39/kWh DC charging
€ 0.35/kWh DC @ **IONITY** Flexible Fast Charger.



Remarkable low TCO:
30% less than comparable ICE model.

1,600 kg
trailer load.

CURVED DISPLAY WITH BMW OPERATING SYSTEM 8. DIGITAL EXCELLENCE MEETS MECHANICAL PERFORMANCE.



BMW Curved Display
→ 12.3" instrument cluster & A 14.9" CID
BMW Head-Up Display (Gen3+).
BMW Operating System 8.
Wide range of driver assistance systems.
BMW IconicSounds Electric in cooperation with
Hollywood superstar Hans Zimmer.



THE BMW i4 IS PAVING THE WAY FOR THE FIRST FULLY ELECTRIC BMW M MODEL.



- » TRUE M PERFORMANCE
- » MORE AGILITY
- » MORE PRECISION
- » MORE EMOTION

► Standard equipment for the BMW i4 M50 also includes:

- Adaptive M Suspension.
- M Sport Brake.
- M Aerodynamic Package.
- M Interior.
- M specific BMW IconicSounds Electric.



THE BMW i4. HIGH VOLTAGE BATTERY.



- ▶ New “low height” battery (just 110mm):
 - ▶ 11 battery modules with 324 battery cells
 - ▶ 83.9 kWh (gross), 80.7 kWh (net), 400 Volt
- ▶ Comparison to BMW i3 (MY 2020): 20% improved energy density (on cell level, based on mass).
- ▶ Each cell individually housed and controlled for longevity and high safety.
- ▶ Enabled for circular economy and 90% cell material recovery.
- ▶ Modular concept for easy exchange of modules in case of repair.

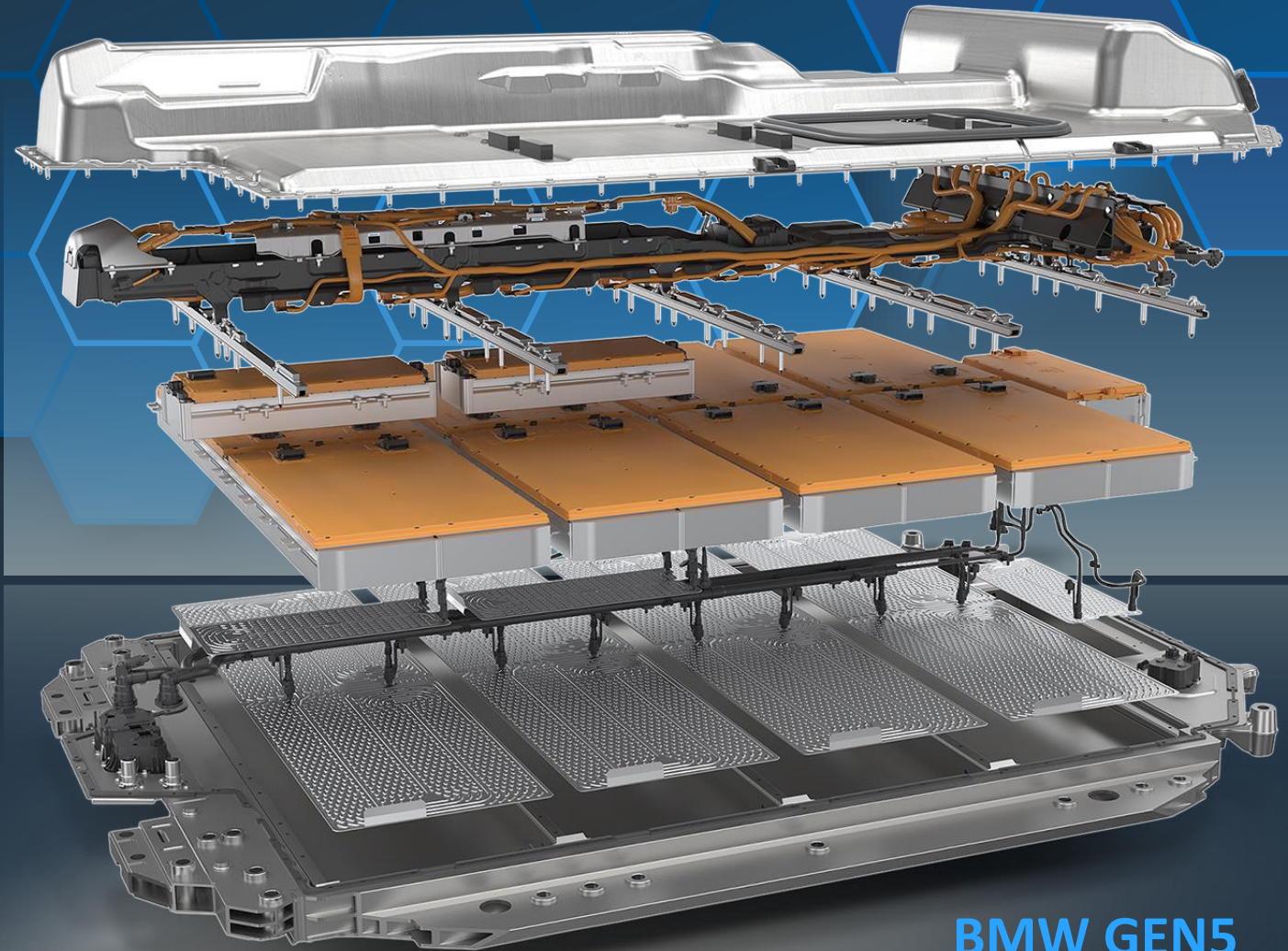

THE BMW i4 eDrive40. E-MOTOR, TRANSMISSION, POWER ELECTRONICS.



- ▶ Use of new EESM* Technology:
 - ▶ Avoiding magnets and Rare Earth Materials.
 - ▶ High peak power & stable torque even at high rpm.
 - ▶ Main contributor to BMW i4 efficiency
- ▶ eMotor, power electronics and transmission in a highly integrated, common housing.
- ▶ 250 kW @ 8,000 –17,000 rpm.
- ▶ 430 Nm @ 0 - 5,000 rpm.

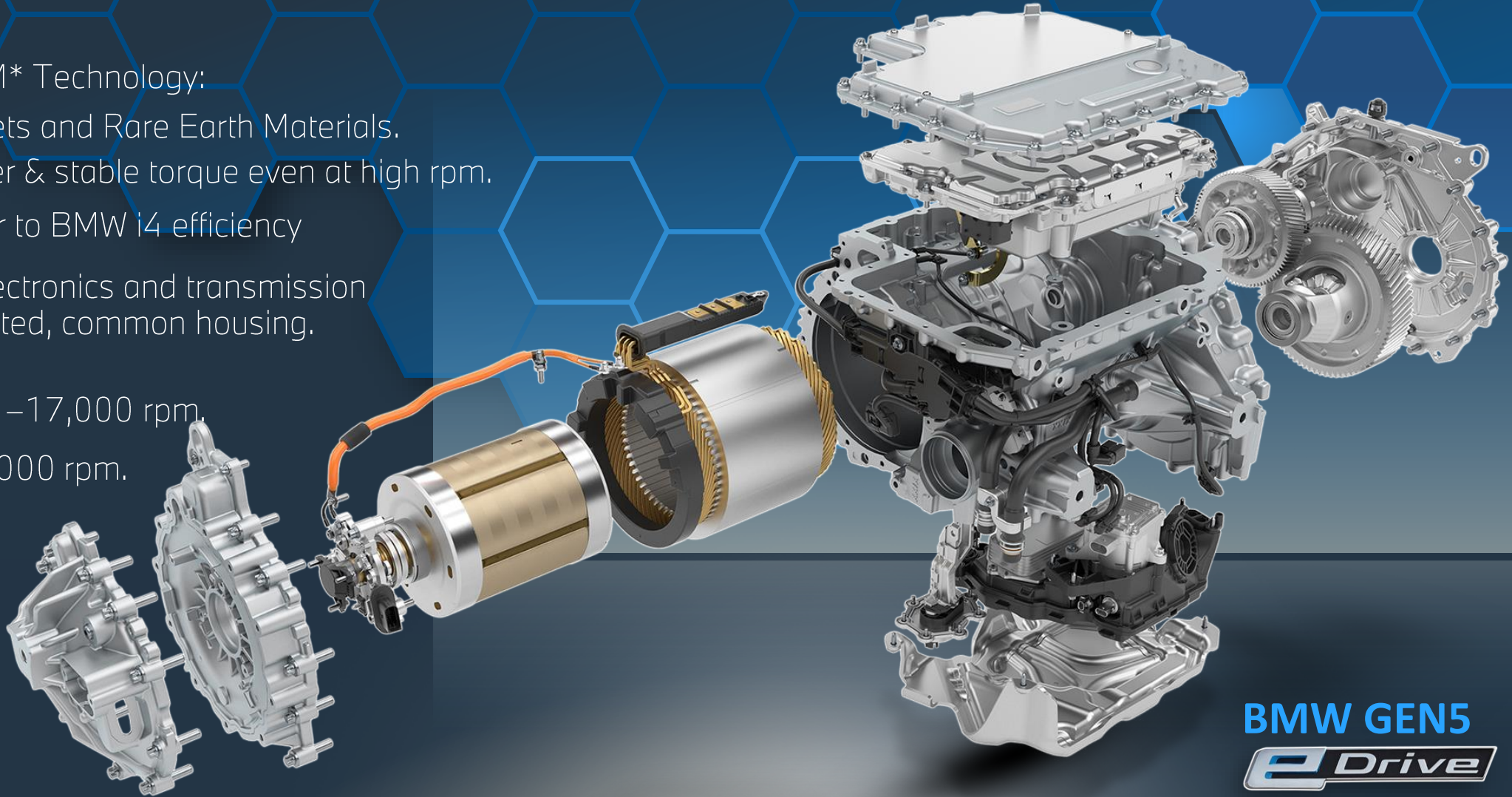

BMW GEN5
eDrive

* Electrically Excited Synchronous Machine.

BMW GEN5. BATTERY-ELECTRIC DRIVE TRAIN ARCHITECTURE COMPONENTS.

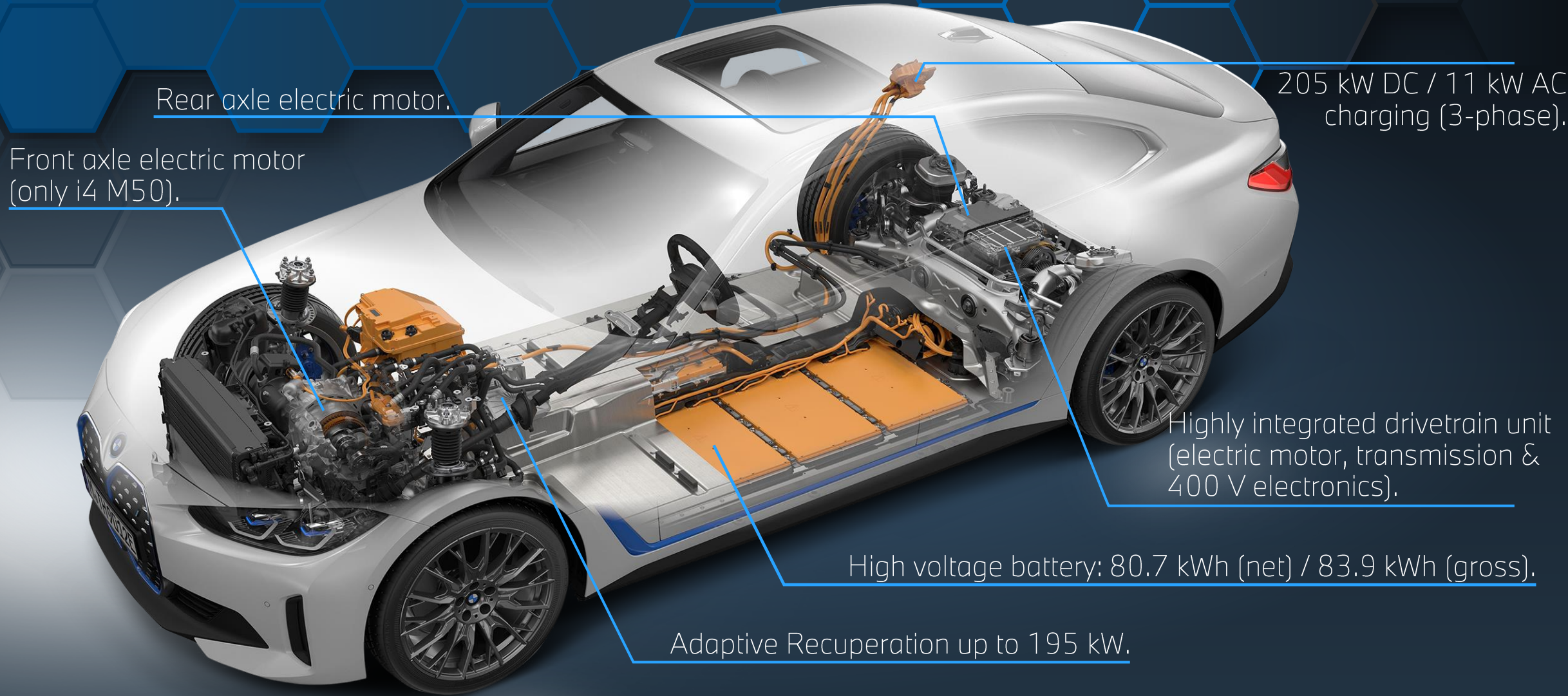

THE BMW i4 M50 CHASSIS.* THE FIRST ELECTRIC BMW M PERFORMANCE MODEL.

Additional bracing elements between the front suspension to increase torsional stiffness.

Gurney flap for reduced aerodynamic lift.

Rear axle with air springs.

Bracing elements for rear axle.

Actuator contiguous wheel slip limitation, ARB-X.

37 mm lower center of gravity*.

Increased track width.*

- ▶ 26 mm front.
- ▶ 12 mm rear.

Adaptive M Suspension as standard incl. VDC & Variable Sports Steering.

* In comparison to BMW 3 Series.

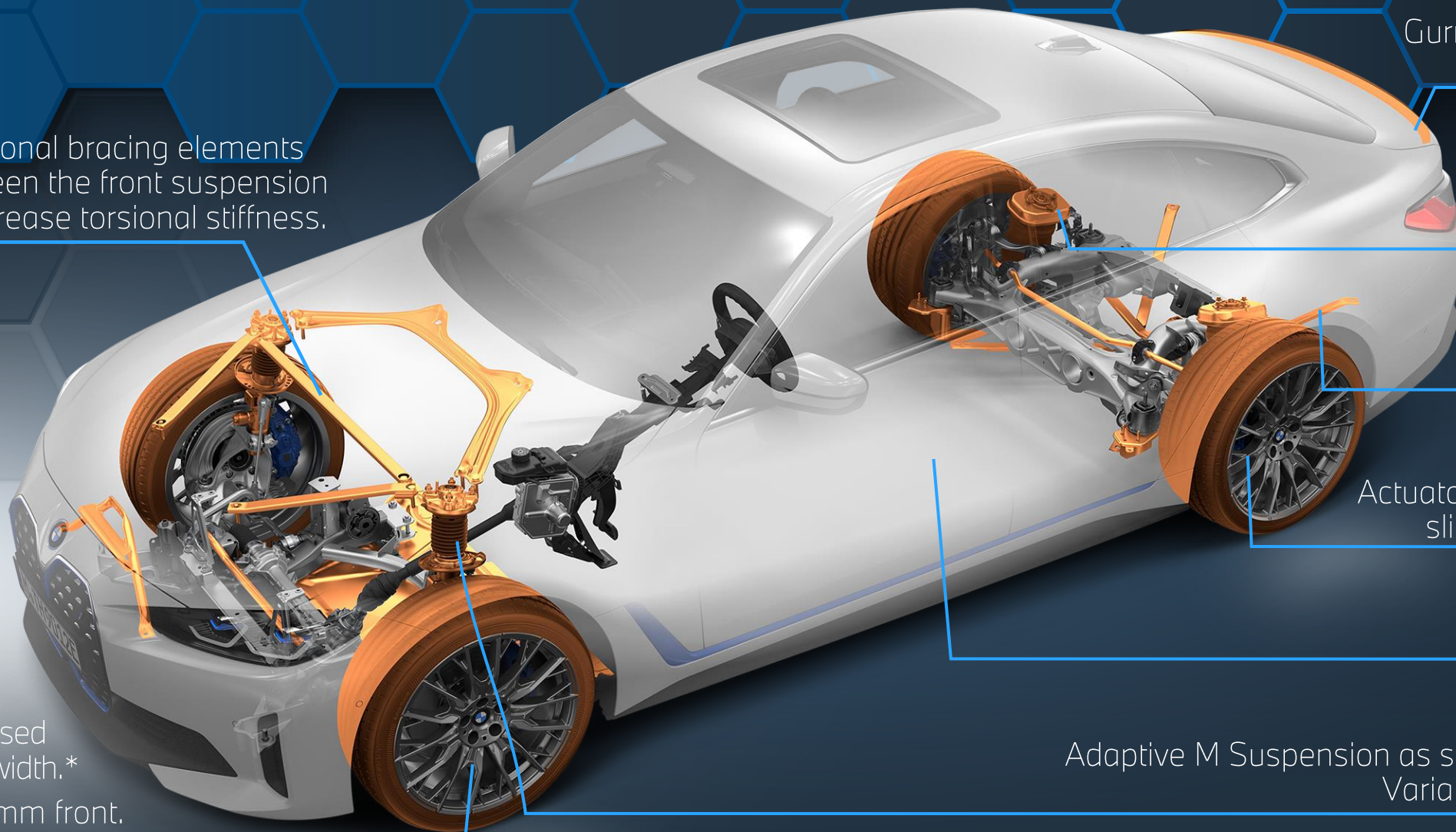

BMW i4. TECHNICAL DATA.



BMW i4 eDrive40

| | |
|--|----------------------------|
| Range (WLTP) | up to 590 km |
| Power | 250 kW / 340 PS |
| Max. DC charging power | 205 kW |
| Added range per 10 mins max. DC charging | 164 km |
| Torque | 430 Nm |
| Acceleration [0 - 100 km/h] | 5.7 s |
| Energy consumption (WLTP) | 16.1 up to 19.1 kWh/100 km |
| Automated driving level | Level 2+ |
| Operating system | BMW OS8 |
| Base price in Germany | 58,300 € |



BMW i4 M50

| | |
|--|----------------------------|
| Range (WLTP) | up to 521 km |
| Power | 400 kW / 544 PS |
| Max. DC charging power | 205 kW |
| Added range per 10 mins max. DC charging | 140 km |
| Torque | 795 Nm |
| Acceleration [0 - 100 km/h] | 3.9 s |
| Energy consumption (WLTP) | 18.0 up to 22.5 kWh/100 km |
| Automated driving level | Level 2+ |
| Operating system | BMW OS8 |
| Base price in Germany | 69,900 € |

THE BMW i4 CHARGING OFFER.

HOME CHARGING



- Flexible Fast Charger up to 11 kW
- BMW Wallbox Next Gen
- Smart Wallboxes & installation services with partners

WORKPLACE CHARGING

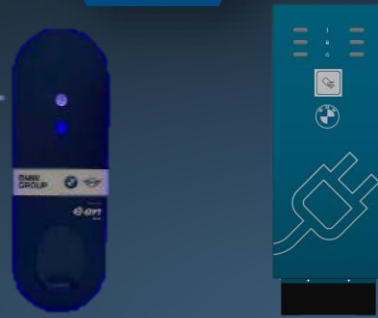

- Fleet solutions with partners:
 - Requirement analysis
 - HW installation & operations
 - Billing solutions
- BMW Employee Charging

PUBLIC CHARGING



- Public Charging cable (EU) ex factory
- Biggest charging network with >450,000 charging points ww
- Attractive, transparent pricing
- No base fee in first year

- Access to ~450 IONITY HPC charging parks in EU (until 2021); ~2,300 charging points in total
- IONITY Plus package for iX3, iX, i4 without base fee in first year

CONNECTED CHARGING SERVICES



- Convenient integration of charging stops into route navigation
- Easy search and access to all relevant charging station information
- Visual indication of range via range circle for planning security

- Full transparency about charging process & time estimation
- Pro-active push notifications (e.g. in case of charging interruptions)
- Transparent charging history



THERE IS NOT "THE BMW i4 CUSTOMER". THE i4 TARGETING CUSTOMERS WITH VARIOUS NEEDS.

MOBILITY

- i4 as 1st car in terms of all-day usability (range & roominess)
- Dynamic driving experience

MINDSET

- Design oriented
- Innovative & loves new technologies
- Value sustainability
- Uncompromising
- Active way of life

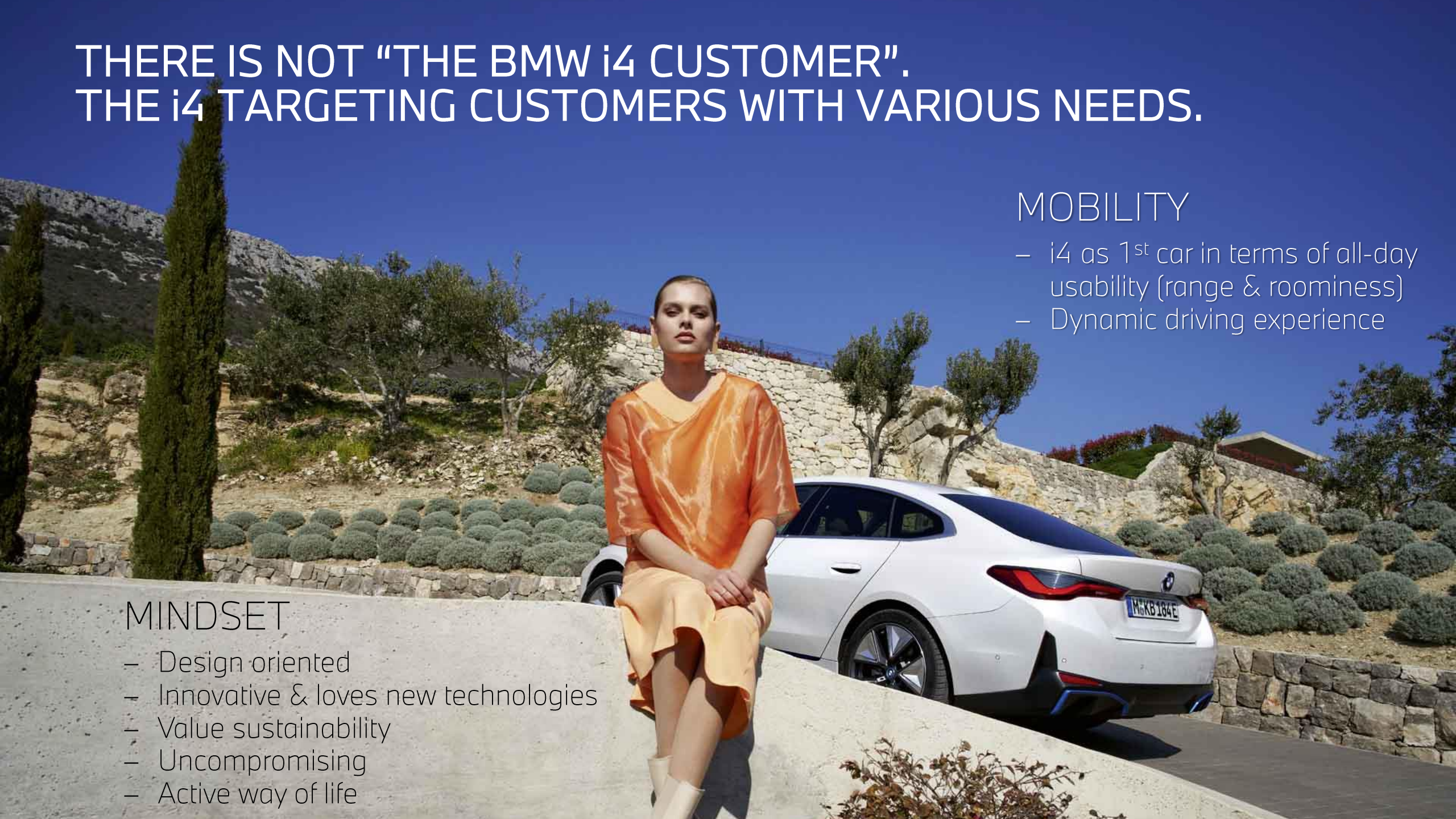

BMW 4 SERIES FAMILY. THE i4 IS THE MOST IMPORTANT MODEL OF THE 4 SERIES FAMILY.

THE 4 Convertible.

~ 16%



THE 4 Coupé.

~ 21%



THE 4 Gran Coupé.

~ 23%



THE i4.

~ 40 %



BMW i4 VOLUME SHARES.



USA
~20%



EUROPE ~60%



CHINA
~10%

THE i4 COMMUNICATION TIMELINE.

